

Continuity solution SPG data sheet

SIZES AVAILABLE L mm: 1000 / 2000

Indicate slots number

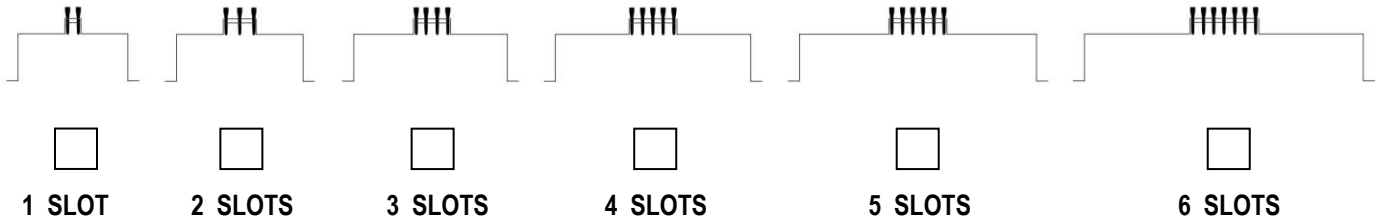

Indicate line length

LINE LENGTH 1: _____ m / _____ mm
 LINE LENGTH 2: _____ m / _____ mm
 LINE LENGTH 3: _____ m / _____ mm
 LINE LENGTH 4: _____ m / _____ mm

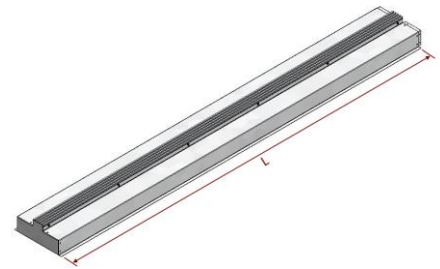

The line will consist of modules of length 2000 mm + a piece of completion.
 For example, for a 9.3 m line, we will supply 4 pieces of 2000 mm + 1 piece of 1300 mm.

Indicate caps number

QUANTITY OF CAPS NEEDED FOR LINE CLOSING: _____ PCS

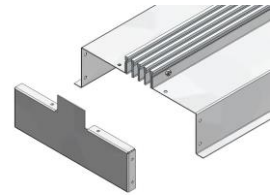

Indicate corners number

QUANTITY OF CORNERS (90°)
 NEEDED FOR THE LINE: _____ PCS

	A (mm)	B (mm)	C (mm)
GRPW 1F	429	411	340
GRPW 2F	425	395	320
GRPW 3F	416,5	373,5	290
GRPW 4F	397,5	342,5	240
GRPW 5F	379	311	190
GRPW 6F	360	280	140

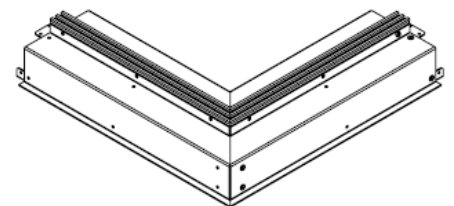
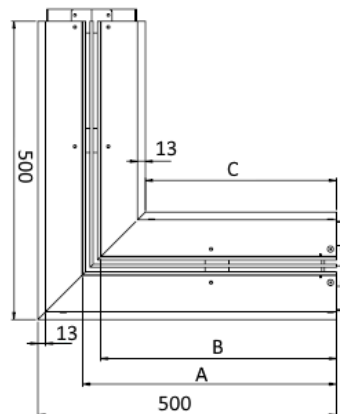

Indicate slots position

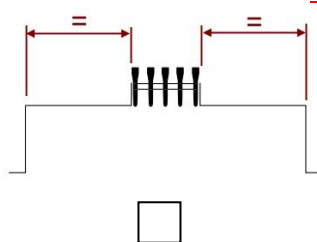

SYMMETRICAL (Standard)

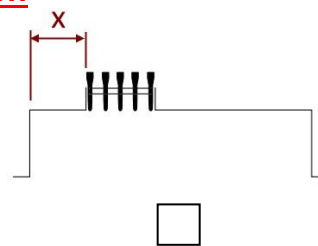

ASYMMETRICAL "X" value: _____ mm