

\* Prüfmaß zur Erstbemusterung (EMPB) und Serie.  
 \*\* Prüfmaß nur zur Erstbemusterung (EMPB).

\* control dimension for initial sampling and in serial production  
 \*\* control dimension only for initial sampling

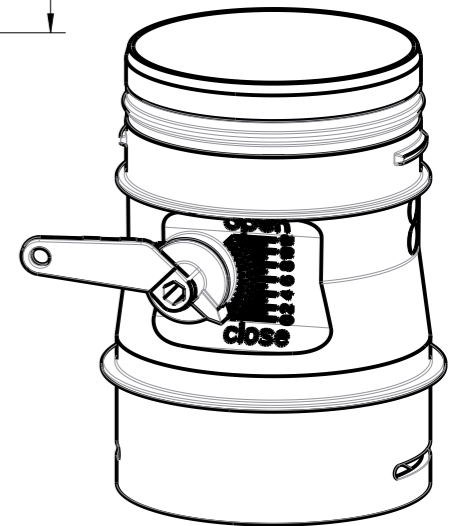

Für diese Unterlage behalten wir uns alle Rechte vor. Schutzvermerk nach ISO 16016 beachten.  
 For this document we expressly reserve all rights. According to ISO 16016.

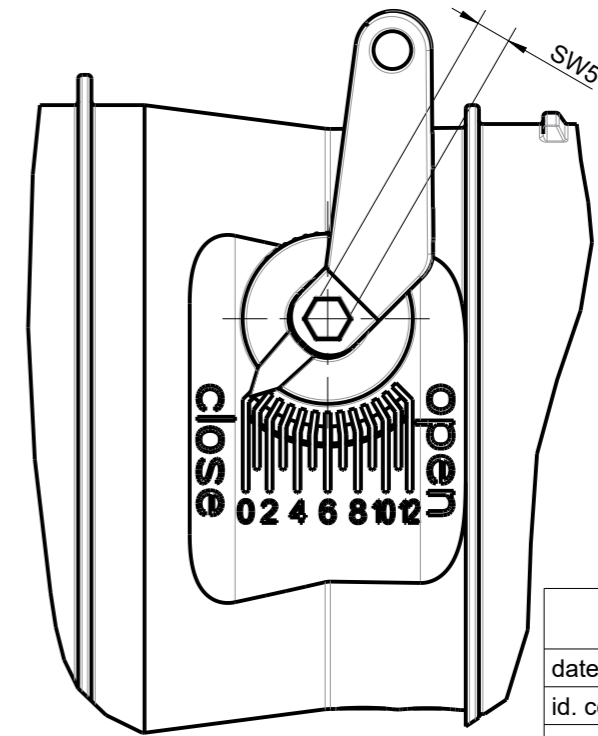
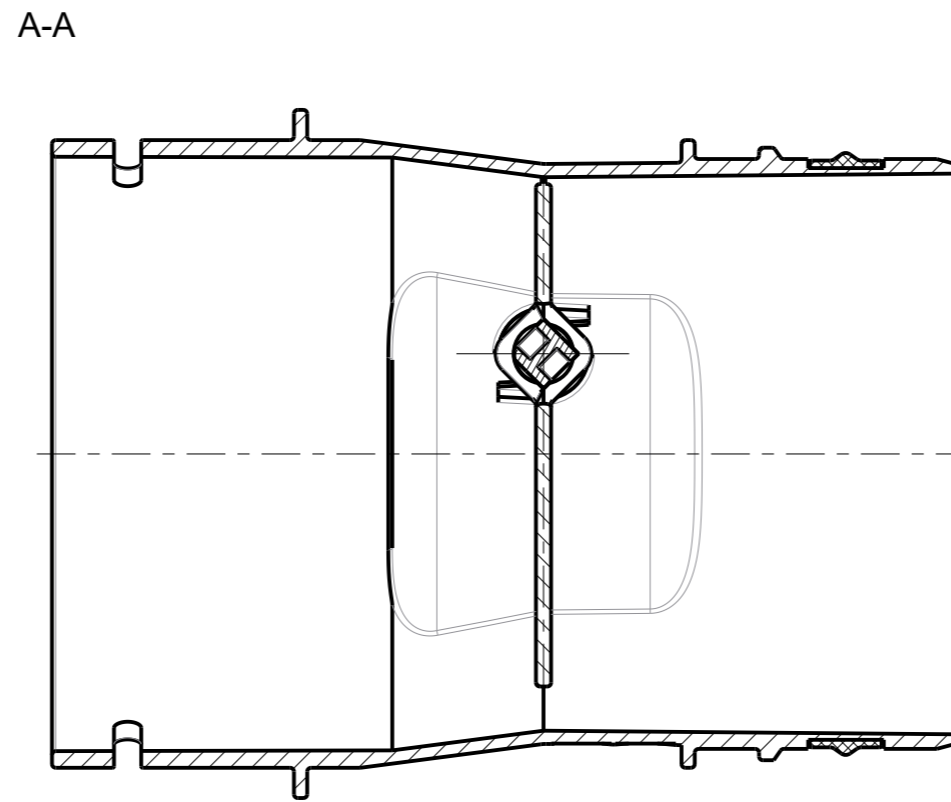
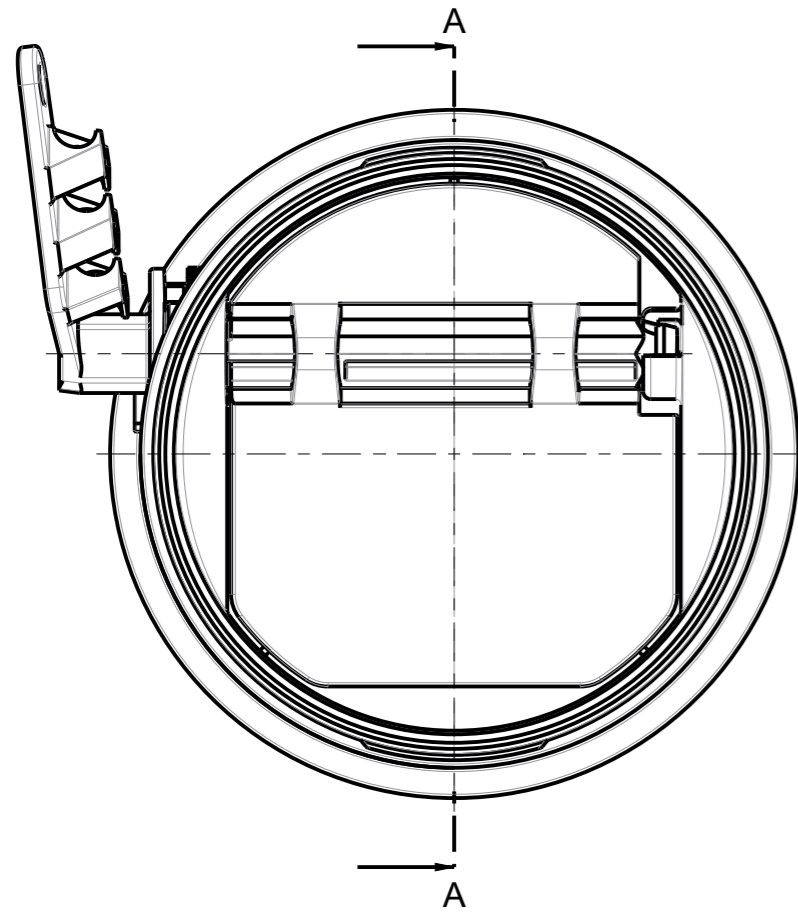

DRAFT DRAWING	
date	13.12.17
id. code	Matthias Ackermann
comment	version - a4

Verstellbereich  
 geschlossen / close Skala 0 = 0°  
 geöffnet / open Skala 12 = 90°

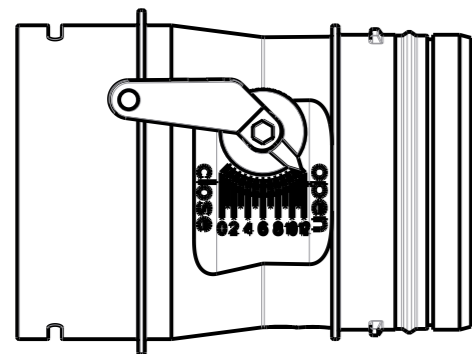

1:2

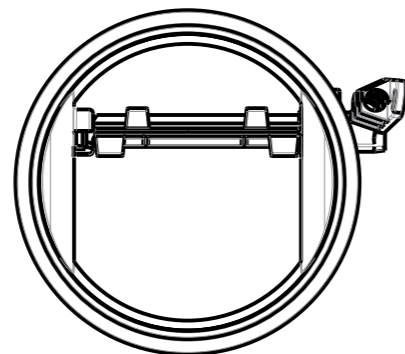

A-A

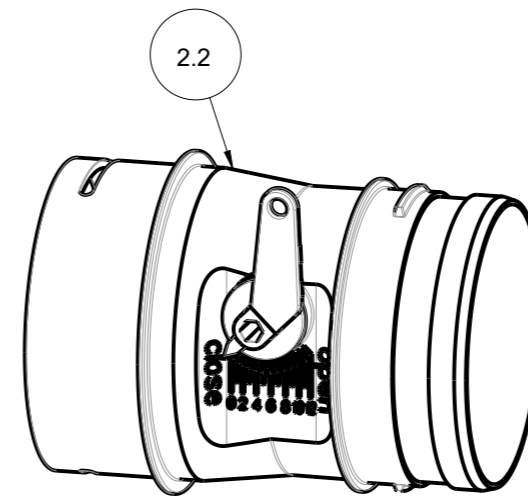
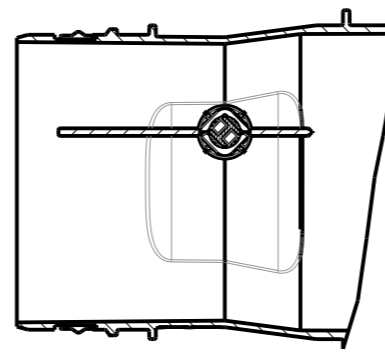

1:2

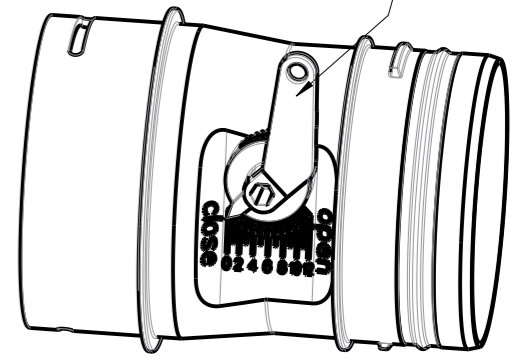
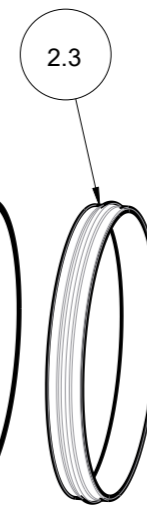

1:2

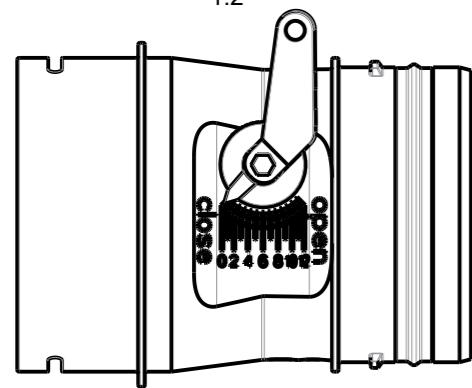

1:2

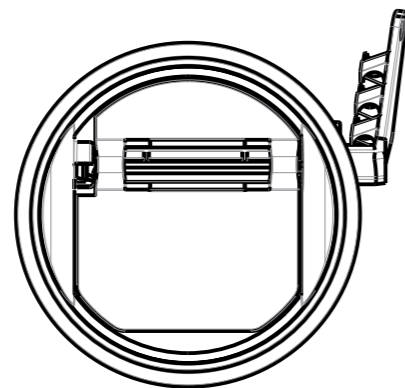

A-A

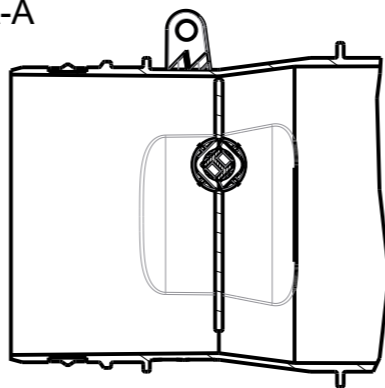

2.3	1	Dichtung 1-lippig	Ø 67.5	EPDM-G-BLK	20-1100006758
2.2	1	Drosselklappe	DN75	PP-GRN/EPDM	20-1100007397
1.1	1	Drosselklappe ew	DN75	PP-GRN/EPDM	20-1100006592
pos.	qty.	description		dim.	material
					drawing no. (layer1)