

- Flanges
- Without rubbersealing



## Straight branches type APD

Straight branche of 90° in galvanized steel.

### Application

- For the connection of round ducts or flexible ducts on to a rectangular duct, plenum box, ...

### Order example

- **APD, 250**

Explanation :

**APD** = Branche type

**250** = Diameter of branche

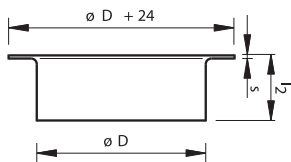

APD	Dimensions		
	$\varnothing D$	$\varnothing D2$	I2
80	80	104	50
100	100	124	50
125	125	149	50
150	150	174	50
160	160	184	50
180	180	204	50
200	200	224	55
250	250	274	60
315	315	339	60
355	355	379	45
400	400	424	45
450	450	474	45
500	500	524	70
560	560	584	70
630	630	654	70
710	710	734	70
800	800	824	70

### Dimensions

For dimensions please check our website [www.cairox.be](http://www.cairox.be)