

Collar saddles with rubber type ARG90

Galvanized steel pressed symmetrical branches 90°, with rubber sealing.
Connection pieces until $\varnothing 200$ with airtightness class D to EN 12237, connection pieces bigger than $\varnothing 200$ with airtightness class C to EN 12237
The airtightness class is also determined by the mounting on the construction site.

Order example

■ **ARG90, 315, 250**

Explanation :

ARG90 = Type of collar saddle

315 = Diameter of main duct

250 = Diameter of branche

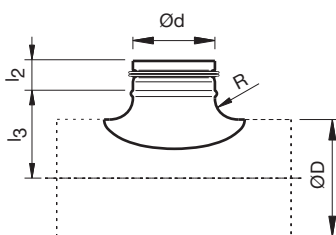

Dimensions

For dimensions please check our website www.cairox.be