

- Quick cable suspension system
- Standard
- Toggle end finishing

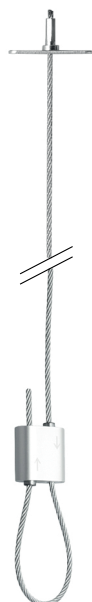

Suspension systems with cable type LS DW

Suspension with toggle anchor

Brand

- SUFIX

Application

- For quick suspension in steeldec

Specifications

- Absorption of vibration of 77% (cfr threaded rods 52%)
- Diameter thread: 1,5 mm
- Breackingforce included safety margin is calculated 1 on 5
- With QS1A quick suspension: 30 kg
- Packaging of 10 cables with 10 QS1A quick locks

Models

- Available in standard lengths of 2 m and 5 m

Related versions

- Dia 3 mm: max. 90 kg available on demand
- Also available with stainless steel cable, on demand
- Upon request available in other lengths

Accessories

- Wire rope cutter, type **PINC**

Text for tender

- Steel galvanized wire cable suspension system with quick locking device **QS1A** for suspension of HVAC devices, ducts, ... The end of the cable is provided with toggle end for fixing into a metal ceiling or on any upper building part
- **Sufix** Type **DW**

Dimensions					
	A [mm]	B [mm]	C [mm]	D [mm]	E [mm]
DW	4.20	5.70	12	5.70	40



Mounting methods

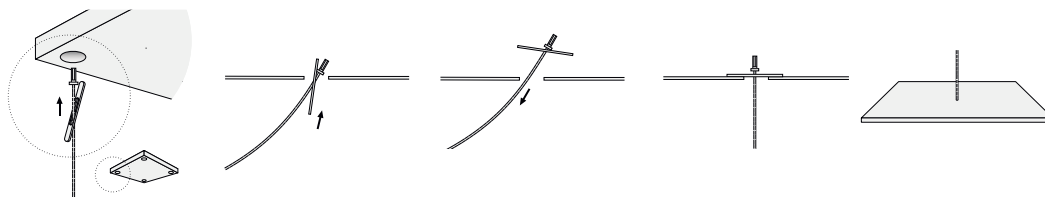

Extra photo

