

Inlet flanges for RL type COL

Inlet flange for **RL**

Composition

- Inlet flange made of galvanised steelsheet

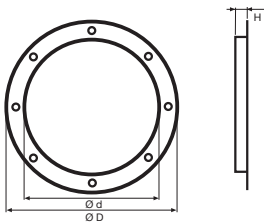

Dimensions			
	Ø D [mm]	Ø d [mm]	H [mm]
COL 310	400	320	110
COL 350	440	360	110
COL 400	485	405	110
COL 450	535	455	110
COL 500	585	505	110
COL 560	665	565	110