

- Without heat recovery
- In line - duct
- Standard or timer
- IPX4
- 50-250m³/h



Duct fans type ILF

In-line axial fans

Application

- Specially designed for ventilation of small rooms
- Available in 3 diameters: 100, 125 and 150 mm
- **The fans have a limited static pressure available (see diagram)**

Composition

- Casing made of white ABS plastic
- Single speed motor
- Supply: 230Vac 1ph
- Protection IPX4

Models

- **ILF 100, 125, 150** duct fan
- **ILF 100T, 125T, 160T** duct fan with timer 2-20 min

Order example

ILF 100
 ILF= fan type
 100= diametre

Air performance data					
	Q [m³/h]				
	20Pa	30Pa	45Pa	60Pa	75Pa
ILF 100	57	25	-	-	-
ILF 125	165	150	25	-	-
ILF 150	255	230	135	60	20

Selection curves

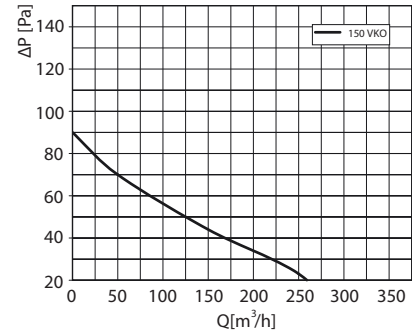
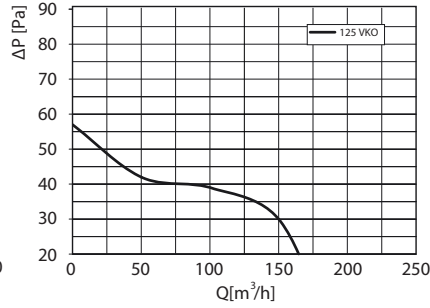
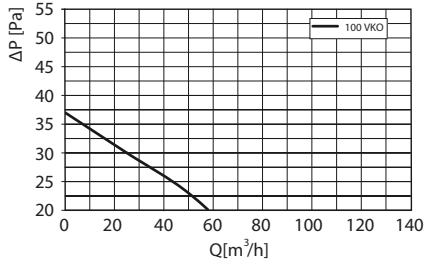

Technical data					
	U [V]	P [W]	I [A]	n [rpm]	Lpa @3m[dB(A)]
ILF 100 VKO	230	14	0.085	2300	37
ILF 125 VKO	230	16	0.100	2400	38
ILF 150 VKO	230	24	0.130	2400	40

Lpa = Sound pressure level

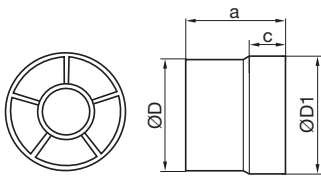

Dimensions					
	a [mm]	c [mm]	ØD [mm]	ØD1 [mm]	[kg]
ILF 100	85	32	100	104	0.61
ILF 125	85	32	125	129	0.65
ILF 150	105	48	150	154	0.69