

Floor collectors type F-COL

Main collector with round connection to spiral ducts **SD** or rectangular connection to **KTL-SD**

Brand

- Ventichape

Application

- This floor collector is designed to be connected to a rectangular duct **KTL-SD** and provides a central and smooth air distribution from the flexible ducts to the various air distribution points
- Connection to a rectangular duct with an airtight piece **MDF** and connection of every flexible duct with a push-in connection **FLEXCON**: this floor collector is equipped with an internal reinforcement (Z-profile) to prevent it from bending

Specifications

- Floor collector made from KTL-coated steel (anti-corrosion)
- Available in 2 types:
 - **F-COL**: floor collector with horizontal connection to rectangular channel
 - **F-COL P**: floor collector with vertical connection to round channel

F-COL 15x50

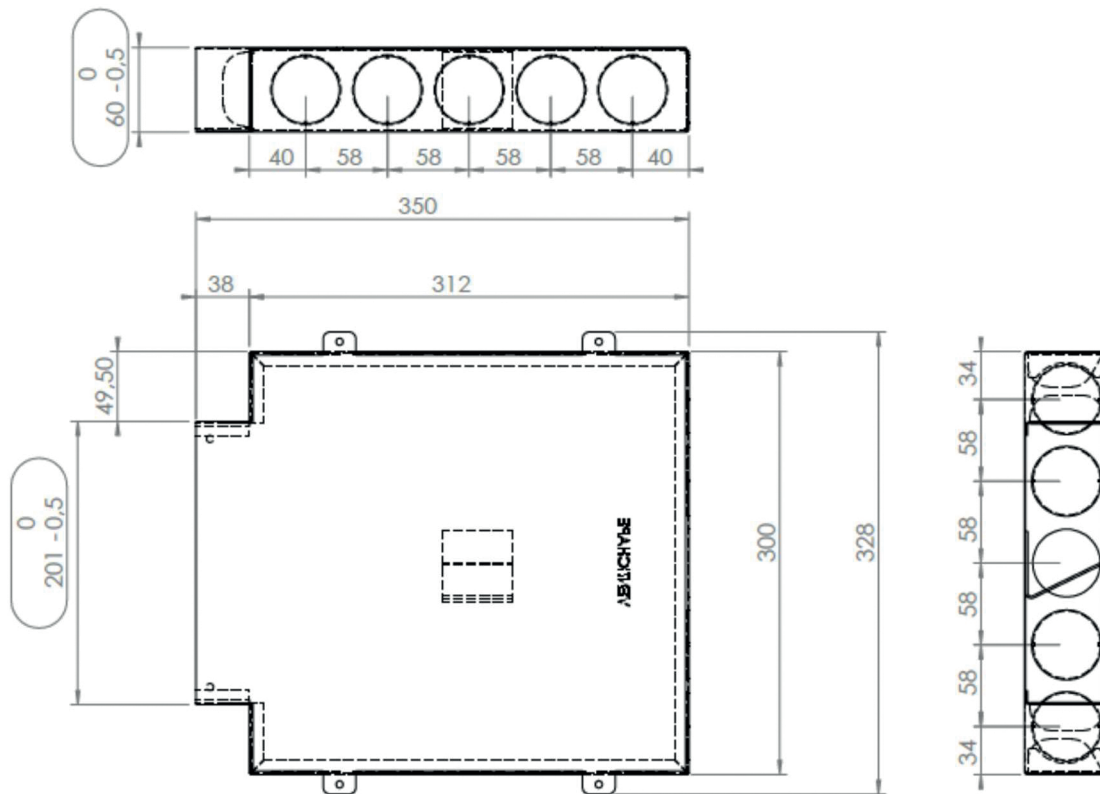

F-COL 150/12x63/70

