

**AmberAir**

- Non residential
- R-COVERY by SALDA
- 5.600-80.000 m<sup>3</sup>/h
- Horizontal/Vertical
- Heat recovery unit with efficiency ≥ 75%



## Modular Air Handling Units type AmberAir

EUROVENT certified modular air handling units AmberAir with basic functions: heating, cooling, filtering, humidification, dehumidification and heat recovery. They are available in 16 different sizes with an overlapping of 5.600 m<sup>3</sup>/h to 80.000 m<sup>3</sup>/h. They are all provided with an excellent thermic and acoustic insulation. Each group can be manufactured on individual request by the customer.

### Application

- Air treatment of commercial and industrial applications
- Air filtration (filters G - F - ...)
- Heating (H<sub>2</sub>O - DX - STEAM)
- Cooling (H<sub>2</sub>O - DX)
- Heat recovery (plate exchanger - rotary wheel)
- Indoor or outdoor installation with roof cap
- Swimming pools
- Hygienic applications
- Adiabatic applications

### Composition

- Double skinned panels
- Structure with aluminium profiles with thermal break and corners out of plastic
- Insulation: mineral wool (45 mm) or injected polyurethane (45 mm)
- Outside: prepainted galvanized steel or not
- Inside: galvanized steel, aluminum or stainless steel
- Rubber seals
- Hinged doors with locking handles
- Aluminium counterflow heatexchanger or condensation, adsorption, hygroscopic or sorption rotor heatexchanger

Optional:

- Inspection windows with or without light
- Protection by epoxy coating
- Adjustable support frame
- Connections to the outside
- Roof and rain canopy for outside

### Specifications

- With (built-in, externally on the housing or at a distance) or without regulation
- Software: VENTMASTER

### Fan

- Fan mounted on a chassis with anti-vibration mounts of rubber
- Different types of fans available: centrifugal fan belt driven with forward or backward curved impeller, direct-driven with AC or EC motor

### Filter

- Mounted on rails and provided by locking rail system
- Filter indication by pressure measurement
- Pre, fine, absolute and active carbon filters

### Certification

- Eurovent certificated
- EPBD certificated

### AmberAir SD50+

- Mechanical strength: D1
- Air tightness: L1(-400 Pa) / L1(+700 Pa)
- Thermal insulation: T2
- Thermal bridge: TB2
- Filter bypass leakage class: F9

### AmberAir MD50+

- Mechanical strength: D2
- Air tightness: L1(-400 Pa) / L1(+700 Pa)
- Thermal insulation: T3
- Thermal bridge: TB2
- Filter bypass leakage class: F9

### Selection curves

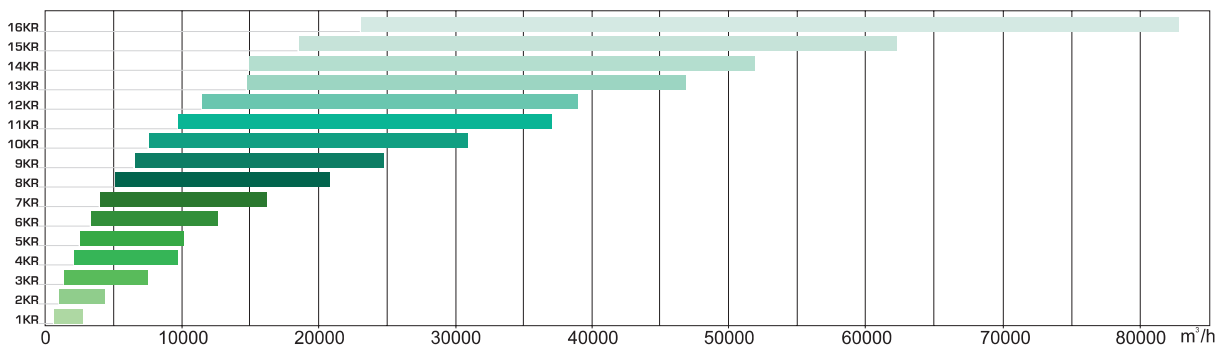

The screenshot displays the SALDA software interface for configuring a heat recovery unit. It includes a 'Size selection' table, a 'Parameters' section for air data and supply/exhaust air, and a 'Components' panel for selecting technical specifications.

Size	A (mm)	B (mm)	Y (mm)
6-KR SW500-1500	1300	1500	1537/1531
7-KR SW500-1700	1360	1700	2164/2164
8-KR SW500-1900	1460	1900	2137/2137
9-KR SW500-2100	1560	2100	1867/1866
10-KR SW500-2300	1660	2300	1550/1550
11-KR SW500-2500	1760	2500	1137/1137
12-KR SW500-2800	1910	2800	686/686
13-KR SW500-3000	2010	3000	677/677
14-KR SW500-3300	2160	3300	676/676
15-KR SW500-3600	2300	3600	656/656

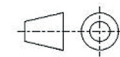
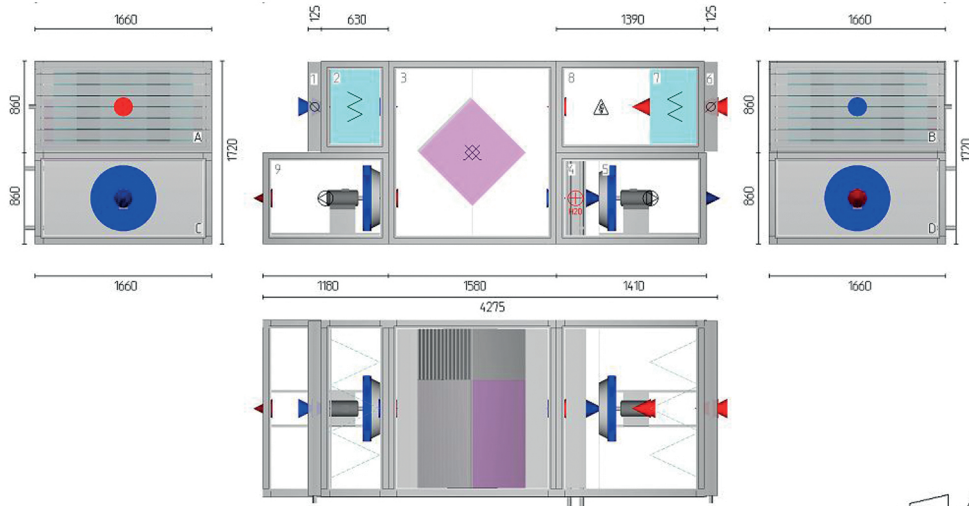

### Prices

Prices, selections and technical specifications are available on demand