

**DMS-W CLICK
OC**

- Mounting ducts and accessories
- Outer bend 90°

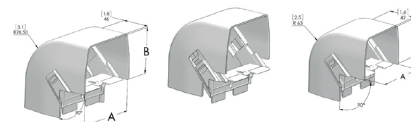

Outer bends 90° (RAL9003) type DMS-W CLICK OC

Outer bend 90°

- Paintable and UV-resistant bend: The colour of the paint should have a clear tone. It must be avoided that the temperature of the painted surface exceeds +60°C. Please contact your paint supplier for further information.
- No screws needed (clicking system)
- M1 fire class

Material

- PVC

Color

- White (RAL 9003)

| Dimensions | | |
|--------------------|--------|--------|
| | A [mm] | B [mm] |
| DMS-W CLICK OC 080 | 80 | 60 |
| DMS-W CLICK OC 110 | 110 | 75 |

Order example

DMS-W CLICK OC 080

Explanation

DMS-W CLICK OC = Type of outer bend 90°

080 = Width

Package

- Box of 6 pieces
- Available per piece
- Price per piece