



Rectangular electrical heating battery type RVA

Rectangular heating element with 50°C maximum outlet temperature
Minimum air speed: 1,5 m/s
Standard dimensions are 400x200 to 1000x500.
Power range from 6 to 90 kW
Operating voltage: 400V triphase

Application

- Electric heaters **RVA** are designed to heat clean air in ventilation systems

Material

- Casing made of aluzinc coated steel, with rubber rings on either side for air tightness
- Heating elements made of stainless steel ASI 304

Specifications

- High temperature proof casing made from aluzinc coated steel
- Heating elements made from stainless steel AISI 304
- Two-stage overheat protection: the first stage switches on when the temperature reaches 50°C (automatic reset), the second stage switches on when the temperature reaches 100°C (manual reset with pushbutton on the casing)
- 20mm duct mouting frame on each side
- No internal temperature controller is provided, external controllers have to be used (see section J11)

Mounting

- Heaters **RVA** can be installed vertically or horizontally
- In case of horizontal instalation, the electrical boxes must be on the left or right side
- The distance between **RVA** and another element (fan, damper,...) must be at least two times the duct size

Accessories

- Room temperature sensors type **TG-R**
- TG-R430** : 0-30°C with setpoint adjustment
- TG-R530** : 0-30°C
- Duct sensor type **TG-K**
- TG-K330** : 0-30°C
- TG-K360** : 0-60°C
- Controller for **RVA**
- Triac type **TTC**
- Sequencer type **TT-S4 (6)**

Text for tender

- The heating batteries shall be electrical, rectangular
- The casing shall be high temperature proof, made from aluzinc coated steel with a 20mm frame for rectangular duct mounting
- The heating elements shall be made of stainless steel AISI 304
- They shall be equipped with automatic and manual overheating protection
- **ATC Type RVA**

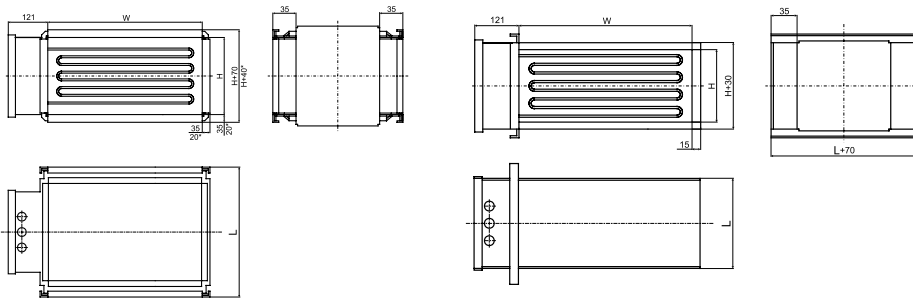

Dimensions															
RVA 400x200															
L [mm]	6	9	12	15	21										
P [kW]															
RVA 500x250															
L [mm]	9	12	15	21	24	36	45								
P [kW]															
RVA 500x300															
L [mm]	9	12	15	18	21	24	27	30	33	36	42	45	600		
P [kW]															
RVA 600x300															
L [mm]	9	12	15	18	21	24	27	30	33	36	42	45	520	600	
P [kW]															
RVA 600x350															
L [mm]	9	12	15	18	21	24	27	30	33	36	39	42	45	500	
P [kW]															
RVA 700x400															
L [mm]	370														
P [kW]	12	15	18	21	24	27	30	33	36	42	45	51	60	66	
RVA 800x500															
L [mm]	370														
P [kW]	15	18	21	24	27	30	33	36	39	42	45	51	54	60	66
RVA 1000x500															
L [mm]	370														
P [kW]	30	33	36	39	42	45	51	54	60	66					